

STARTER KIT FOR SMARC 2.0 DEVELOPMENT

conga-SKIT/ARM i.MX8

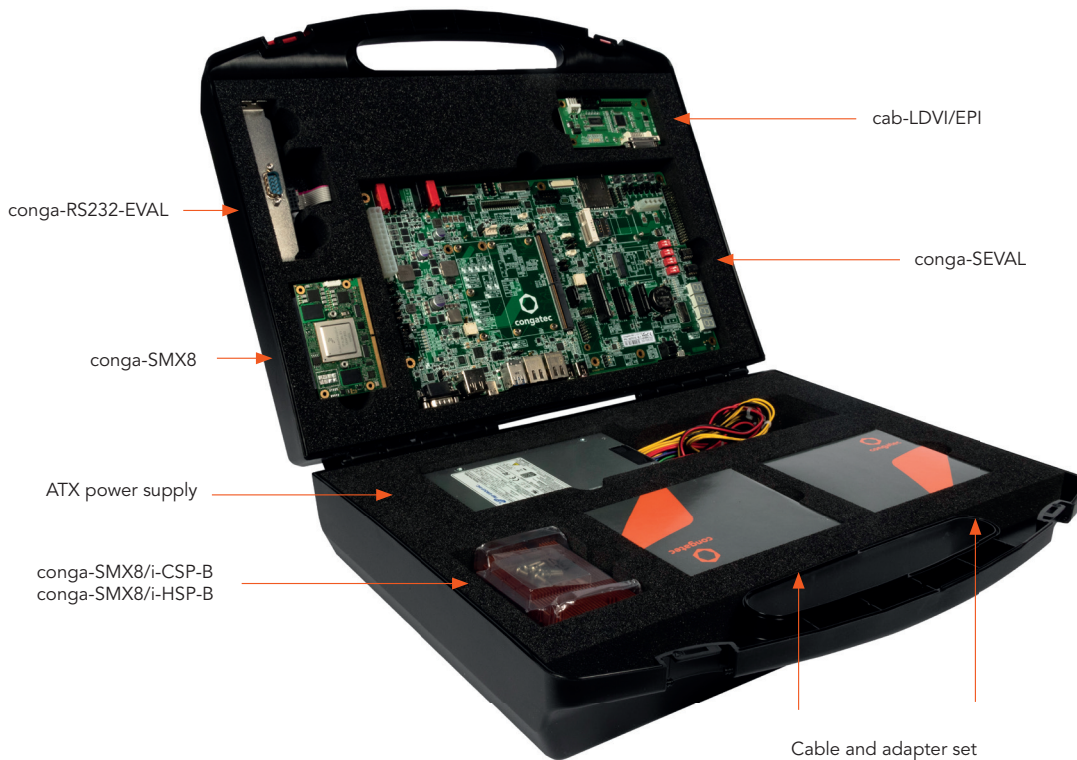

The conga-SMX8 features application processors from the NXP i.MX8 product family with up to 8 GB LPDDR4 onboard RAM and 16 GB onboard HS400 eMMC. It is available in commercial and industrial temperature range. The conga-SEVAL evaluation carrier board provides 1x PCIe x1, 1x mPCIe, 1x M.2 Key E, 1x USB 2.0 OTG Micro AB, 1x USB Type A, 1x USB 2.0 Type C, 1x USB 3.1 Type-C, 1x USB 2.0 on M.2, and 1x USB 2.0 on mPCIe. It also provides 2x RJ45 for Gigabit Ethernet, 4x COM, 2x CAN bus, 12x GPIO, Digital and analog audio I/Os for I2S and HDA. Displays can be connected via dual channel LVDS, eDP, DP and HDMI. Additional storage media are available via a SD/MMC socket and 1x SATA 6 Gbps port.

| Article | PN | Description |
|-----------------------------------|----------|--|
| conga-SEVAL | 007010 | Evaluation carrier board for standard SMARC modules based on SMARC Specification 2.0 |
| conga-SMX8/i-QCM-6GB eMMC16 | 051020 | SMARC 2.0 module with NXP i.MX8 QuadMax application processor, 1 MB L2 cache, 6 GB LPDDR4 onboard memory and 16 GB on-board HS400 eMMC |
| MicroSDHC-Card UHS-I | 10000285 | 8GB - Kingston industrial SDCIT/EU Class 10 with preinstalled image |
| conga-SMX8/i-CSP-B | 051050 | Passive cooling solution. All stand-offs are bore hole 2.7mm |
| conga-SMX8/i-HSP-B | 051051 | Standard heatspreader. All stand-offs are bore hole 2.7mm |
| conga-LDVI/EPI | 011115 | LVDS to DVI converter board for digital flat panels with onboard EEPROM |
| conga-ACAM/JAL-2721 | 016153 | MIPI camera module adapter with camera JAL-2721. Image sensor OV5640. MIPI CSI-2 |
| Flat Foil Cable | 48000026 | FFC for conga-ACAM/JAL-2721. 36 pins, pitch 0.5mm, length 150mm, opposite side contact |
| cab-LVDV-DAT-34-15 | 033331 | 15cm data cable LVDS to DVI adapter |
| cab-LVDV-PWR-10-15 | 052147 | 15cm power cable LVDS to DVI adapter |
| USB 2.0 to Serial Adapter | 10000116 | USB 2.0 to Serial Adapter DSUB9 based on FTDI FT232 |
| cab-RS232-EVAL | 14000200 | 20cm 2x5pin female to D-Sub 9P male |
| SATA power cable 12cm | 14000202 | 12cm SATA HDD 15pin SATA to 4pin ATX |
| RS232 adapter cable | 48000023 | MOLEX 6-Pin PicoBlade to two D-SUB 9 |
| SATA III cable 30 cm | 48000029 | 30cm SATA III cable, straight / straight |
| ATX Power Supply | 500016 | FSP180-50L max. 180 W (150 x 81.5 x 40.5 mm) |
| Quick Start Guide | 85500014 | Quick Start Guide |
| Safety and Regulatory Information | 91500002 | Safety and Regulatory Information |
| Wireless Content Information | 91500003 | Wireless Content Information |

| Article | PN | Description |
|----------------------|--------|---|
| conga-SKIT/ARM i.MX8 | 077660 | SMARC 2.0 IoT Development Kit based on conga-SMX8 with NXP i.MX8 series processor and conga-SEVAL SMARC reference carrier |